

द्वि. वि. प्रा. द्वारका उपशहर परियोजना

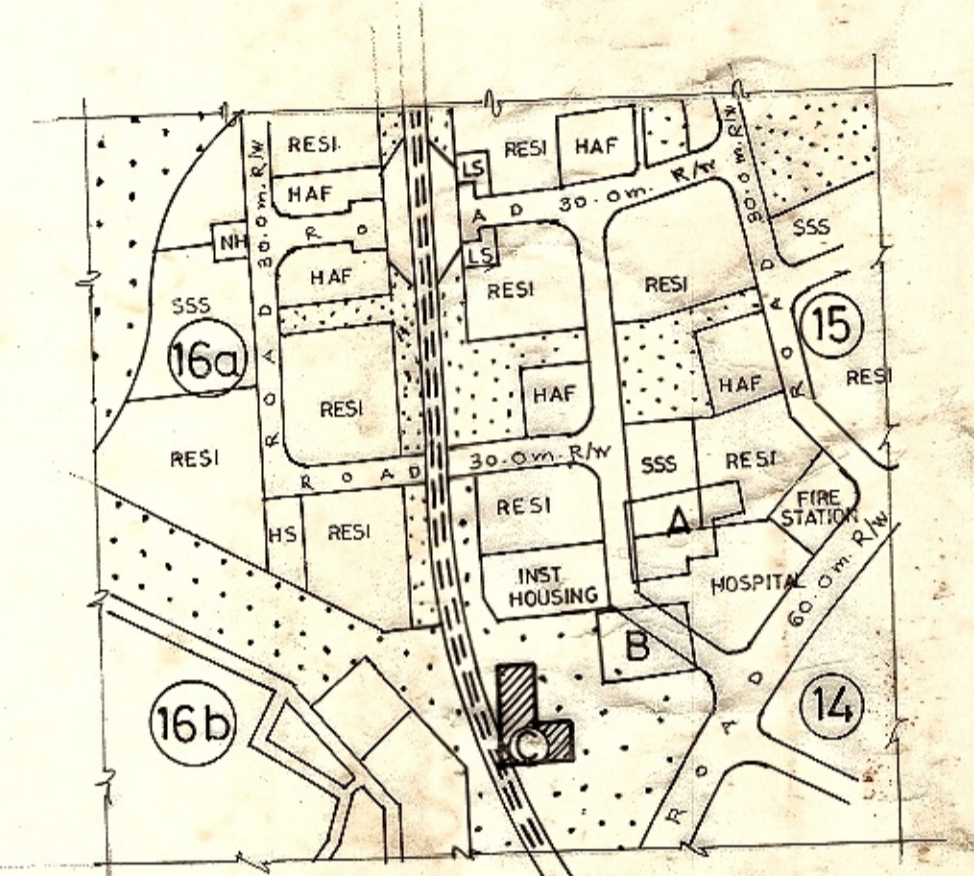

LOCATION PLAN
(w.r.t. APPROVED SECTOR PLAN)

NOTE:-
INCORPORATED BASTI VIKAS KENDRA & SHISHU VATIKA SITE ON TOT LOT/OCF PLOT APPROVED BY COMM. (PLG) IN FILE NO F13(15)/2001/PLG/DWK DT. 9.1.2002 ON PAGE NO 4/N & DRAFT PLAN NO 21/C.

AREA STATEMENT
TOTAL AREA OF THE POCKET 15748 Sq.m.

USES	AREA (in Sq.m)	%age
RESIDENTIAL	6375	40.5
O C F	710	4.5
GREEN	1653.5	10.5
CIRCULATION	7009.5	44.5

NO. OF PLOTS 510
SIZE OF PLOT 2.50m X 5.00m = 12.5 sqm

- NOTES:-
- THE DRAWING IS PREPARED BASED ON THE P.T. SURVEY SUPPLIED BY J.D.(S) SURVEY.
 - LAYOUT PLAN APPROVED BY V.C. VIDE ORDERS DATED 5.6.98 ON PAGE-14/N IN FILE NO F4(15)94/DWK/DDA.

LAYOUT PLAN OF TRANSIT CAMP

VACANT POCKET - C (SECTOR - 15)			003/TC/PKT-C/SEC-15/ DRG. NO. DWK-98
PLG. D/MAN sd/ A.K. MANNA DY. DIRECTOR	REETA SEHGAL PLG. ASSTT. sd/ A.K. GUPTA DIRECTOR (PLG)	sd/ 28.5.98 M.L. CHHABRA ASSTT. DIRECTOR N.K. AGGARWAL O.S.D.(PLG) CO-ORD.	1:500 SCALE VIJAY RISHBUD COMMISSIONER (PLG)
दिल्ली विकास प्राधिकरण			

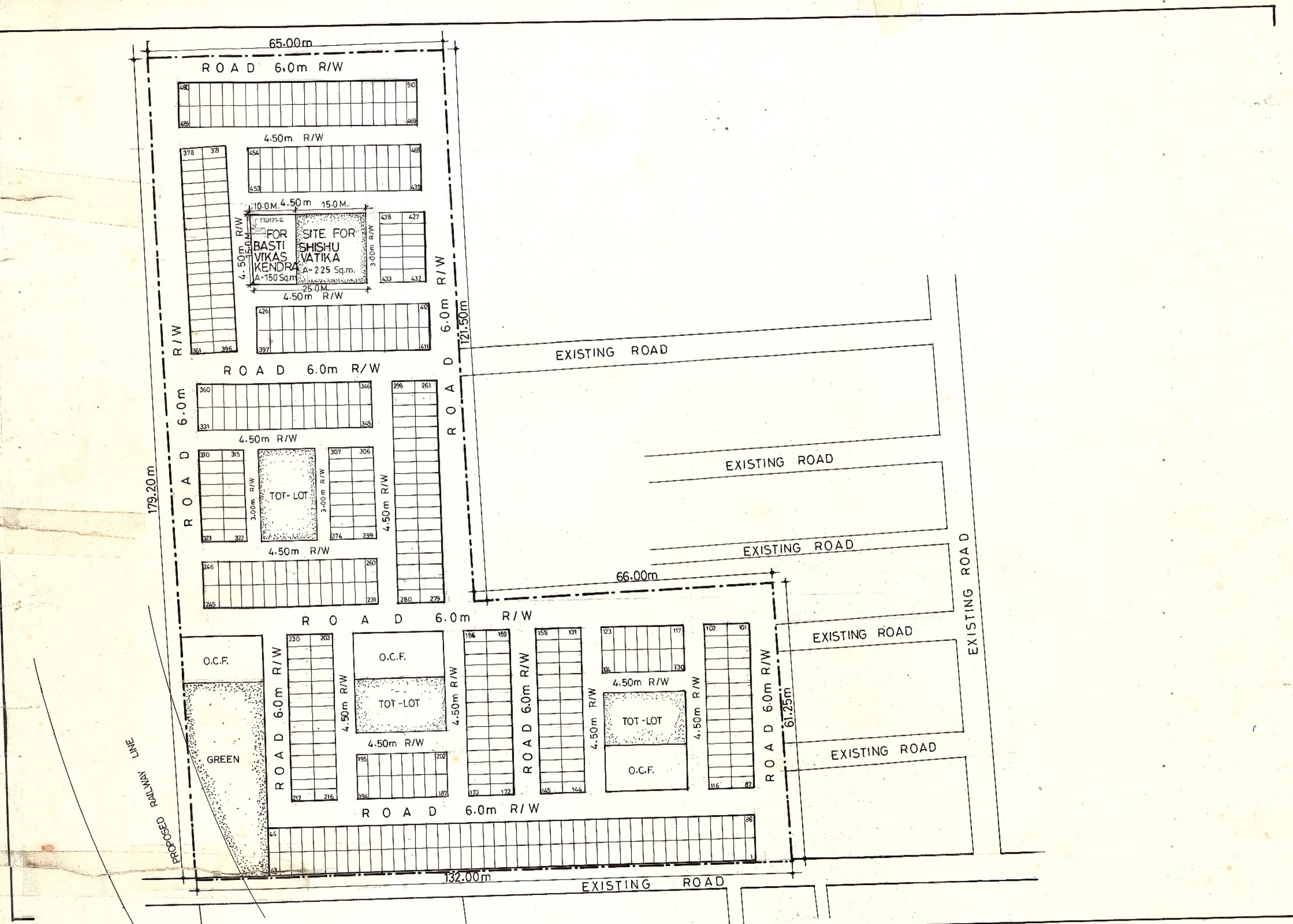

द्वारका SUB-CITY (PAPANIKALAD)

